

Bedford County
George Hull
172^{as} 86^{ps}.
and all^e
xs. wt for 100^{as}

Ret^d & c. 6th Oct. 1864
in. al.

N^o 560
Accepted 11th April 1821

EDMUND

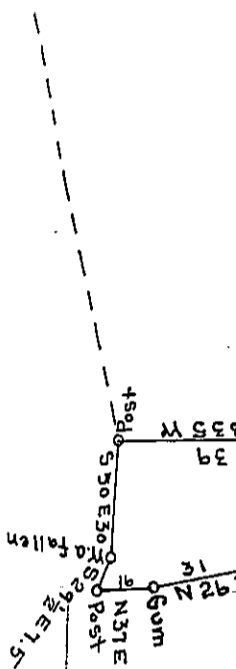

Carli

A Draft
County,
dred an
of Marc
ined an
a Warra
1859.
Hon. Jav
Sury

IN TESTI